

Installation Guide

Eppendorf Xplorer® connect
English (EN)

1 About this manual

1.1 Notes on this manual

This document supplements the operating manual of the product. This document does not replace the operating manual.

1. Read these instructions for use before using this product.
2. In addition, read the operating manual of the device with which you are using the accessories.

1.2 Other applicable documents

The following documents supplement this manual:

- Eppendorf Xplorer/Eppendorf Xplorer plus operating manual
- Pipette Manager installation guide
- Pipette Manager operating manual

1.3 Intended use

The "Eppendorf Xplorer connect" radio module is designed as a modification kit for the electronic pipettes of the "Eppendorf Xplorer" and "Eppendorf Xplorer plus" with a USB port and an **On/Off** switch.

1.4 Residual risks when used as intended

If the product is not used as intended, the installed safety devices may not function correctly. To reduce the risk of personal injury and material damage and to avoid dangerous situations, please observe the general safety instructions.

1.4.1 Personal injury

When handled incorrectly, the rechargeable battery may burst open. Persons may be injured.

- Only use a rechargeable battery from Eppendorf SE.
- Only use the rechargeable battery in the supplied device.
- Never pierce, crush or throw the rechargeable battery.
- Do not touch a leaking rechargeable battery.
- Do not use a damaged rechargeable battery.
- Dispose of rechargeable batteries in accordance with legal requirements.

2 Installation Guide

2 Eppendorf Xplorer® connect English (EN)

2 Product description

2.1 Checking the delivery

Delivery overview

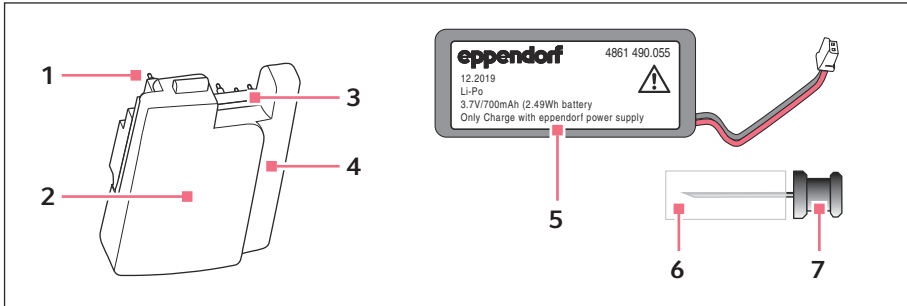

Fig. 2-1: Radio module for Eppendorf Xplorer and Eppendorf Xplorer plus

- | | | | |
|---|------------------------------------|---|--|
| 1 | Contact pins | 5 | Li-polymer rechargeable battery, 700 mAh |
| 2 | Identification of the radio module | 6 | Foam protection |
| 3 | Recess for connector | 7 | Pin |
| 4 | Indent for cable | | |

Checking the delivery



Do not use the product if the packing or the contents are damaged. In case of damaged or missing parts, contact the Eppendorf SE customer service or your Eppendorf partner.

1. Check the packing and the contents for any visible external damage.
2. Check whether the delivery is complete and matches the order.

Quantity	Description
1	"Eppendorf Xplorer connect" radio module
1	Li-polymer rechargeable battery, 700 mAh (short form)
1	Pin (for opening the USB cover)
1	"Eppendorf Xplorer connect" installation guide

2.2 Features

The radio module facilitates the wireless exchange of data between the electronic pipette in **Opt** operating mode and the "Pipette Manager" control panel.

3 Installation

3.1 Inserting the radio module

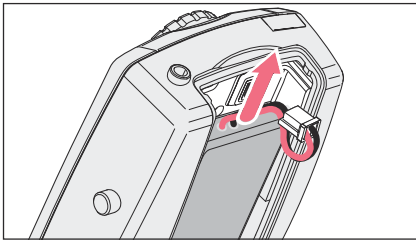

1. Open the rechargeable battery compartment lid.
2. Remove the long rechargeable battery (750 mAh).

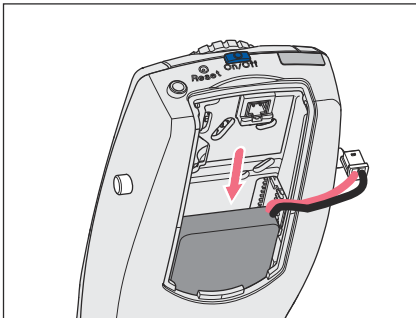

3. Insert the short rechargeable battery (700 mAh) with the cable pointing to the right.

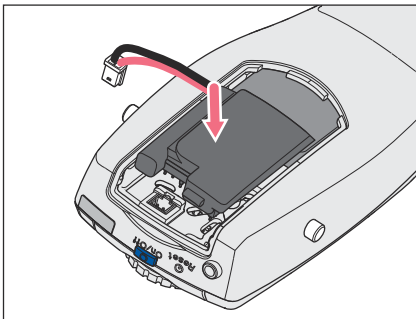

4. Place the radio module loosely on the PCB.
The contact pins only touch the contact points on the PCB.

Installation Guide

4 Eppendorf Xplorer® connect English (EN)

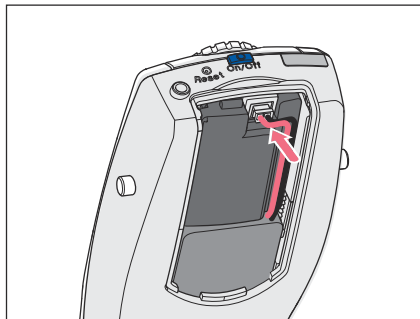

5. Guide the rechargeable battery cable along the side of the radio module and insert the plug.

The cable secures the radio module and connects the rechargeable battery to the PCB.

6. Replace the rechargeable battery compartment lid.
7. Set the *date* and *time* (Eppendorf Xplorer plus only).

The pipette is ready for the radio link to the control panel (Pipette Manager).

3.2 Charging the rechargeable battery

1. Fully charge the rechargeable battery before updating the software.



Information on how to charge the rechargeable battery can be found in the pipette operating manual.

3.3 Updating the pipette software

After installing the radio module, the pipette software must be updated.



The software update procedure is described in the "Pipette Manager" installation guide.

Once the firmware has been successfully updated, the *Option* menu is extended by the *Wi-Fi* submenu.

Menu	Submenu	Description
<i>Wi-Fi</i>		
	<i>Wi-Fi on/off</i>	Activate or deactivate the radio interface.
	<i>Connect AUTO</i>	The settings for the radio network are automatically determined and entered. The <i>Pair New Pipette</i> function in the Pipette Manager must be activated for this.
	<i>Connect MAN</i>	The settings for the radio network must be entered manually.

Menu	Submenu	Description
	<i>Recent connections</i>	List of the recent radio links.
	<i>Delete connection</i>	Delete the radio link.
	<i>Status</i>	Display of the current connection data.
	<i>Version</i>	Display of the software and hardware version of the radio module.

4 Technical data

4.1 Radio module

Transmitting power	max. 0.088 W
Power level	≤ 20 dBm
Frequency band	2400 Hz – 2483.5 Hz
Radio channel	1
Approval	FCC, IC
Standard	802.11 n

4.2 Rechargeable battery

Type	Li-polymer rechargeable battery
Design	Short
Nominal capacity	750 mAh
Nominal voltage	3.2 V
Charge time	1 h
Weight	16 g